

## Magnetic drive pumps MX series

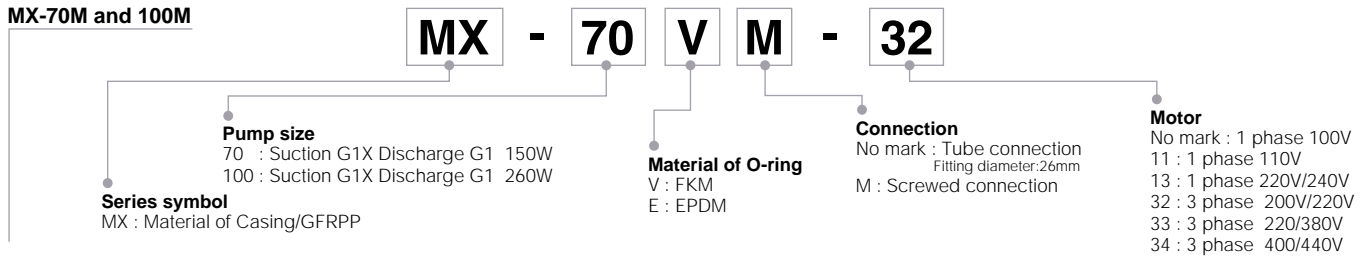

## Pump identification

### MX-70M and 100M



### MX-250 to 403(H)

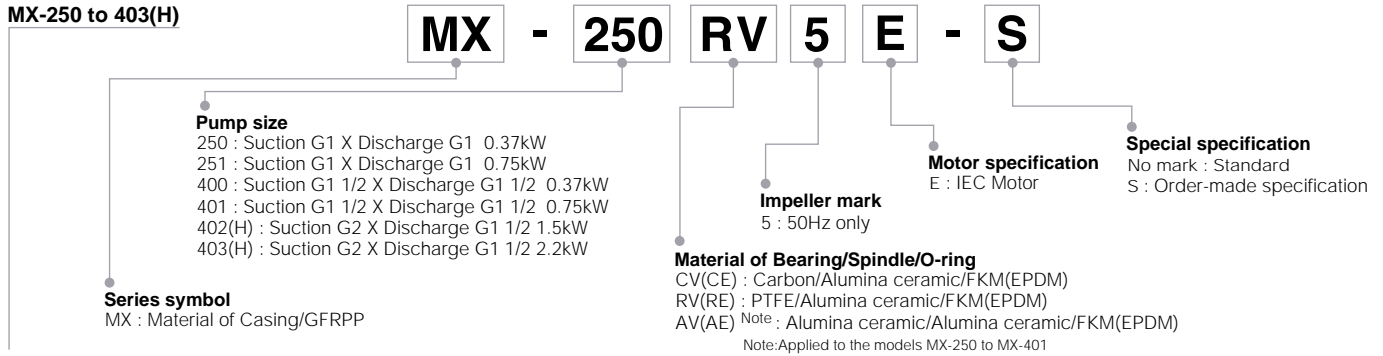

## Specifications

50Hz

Model	Connection Suction X Discharge	Impeller	Limit of specific gravity	Minimum capacity L/min	Standard capacity L/min - m	Maximum capacity L/min	Motor kW
<b>MX-70M</b>	G1 x G1	-	1.2	1	50 - 5.4	90	0.15
<b>MX-100M</b>	G1 x G1	-	1.2	1	70 - 6	110	0.26
<b>MX-250</b>	G1 x G1	5	1.2	10	50 - 14	150	0.37
<b>MX-251</b>	G1 x G1	5	1.0	10	80 - 19	150	0.75
<b>MX-400</b>	G1 1/2 x G1 1/2	5	1.2	10	100 - 10.5	280	0.37
<b>MX-401</b>	G1 1/2 x G1 1/2	5	1.2	10	150 - 14.5	320	0.75
<b>MX-402</b>	G2 x G1 1/2	5	1.2	20	200 - 20	450	1.5
<b>MX-402H</b>	G2 x G1 1/2	5	1.0	20	100 - 30	160	1.5
<b>MX-403</b>	G2 x G1 1/2	5	1.2	20	250 - 23	500	2.2
<b>MX-403H</b>	G2 x G1 1/2	5	1.0	20	100 - 35	300	2.2

- Note 1) The specific gravity limit values shown above are with maximum discharges.  
The specific gravity limit varies with the discharge. For details, please contact us.
- Note 2) 26mm tube connection option available on the MX-70 and MX-100.
- Note 3) AV(AE) type is different in discharge capacity. For details, please contact us.
- Note 4) Dry run applies to "CV(CE)" type only.
- Note 5) Flange connection is also available as option.

### Common specifications

Range of liquid temperature : 0 to 80°C (10 to 80°C in case AFLAS® O-rings are used.)  
Range of ambient temperature : 0 to 40°C.

Performance curves

50Hz

**MX-70(M),100(M)**

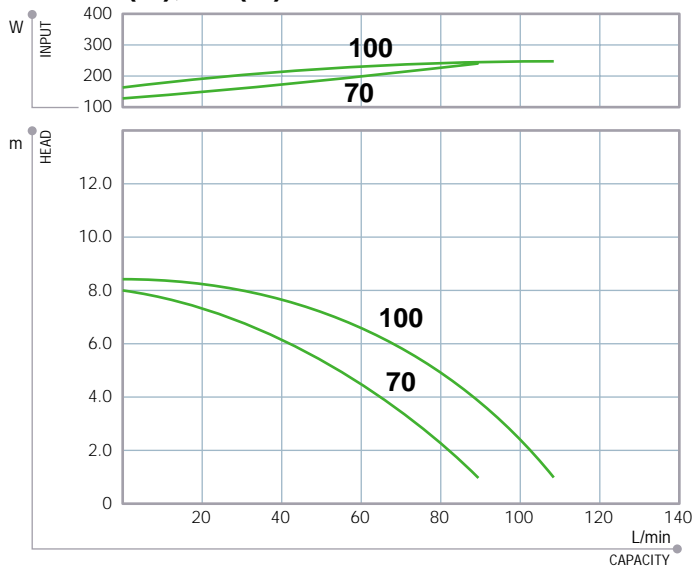

**MX-400, 401**

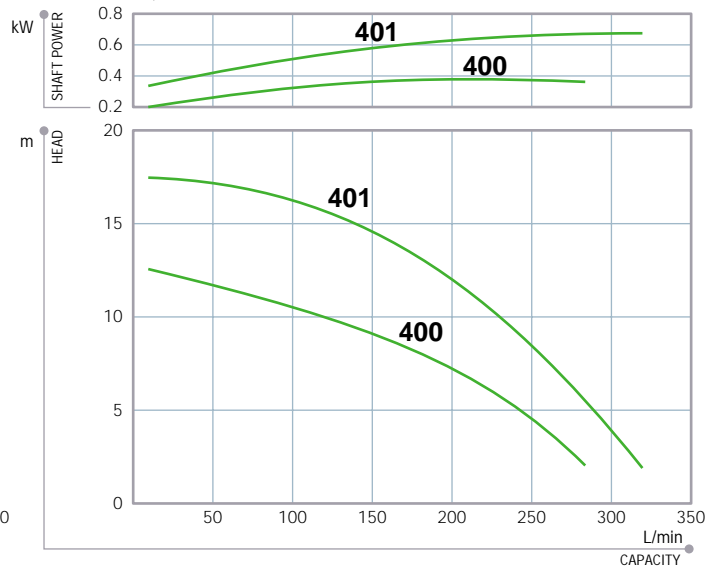

**MX-250, 251**

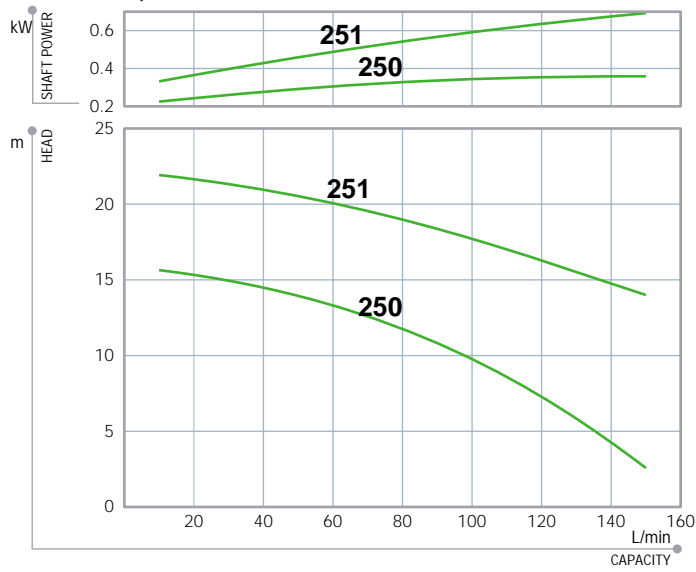

**MX-402, 402H**

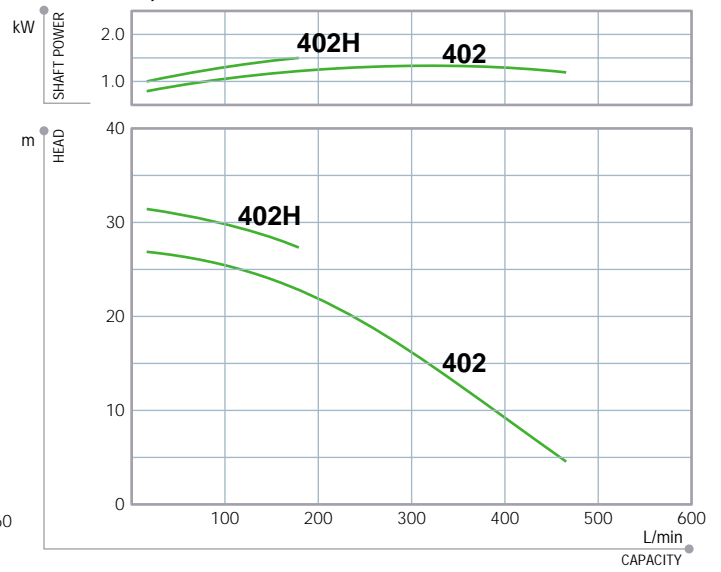

**MX-403, 403H**

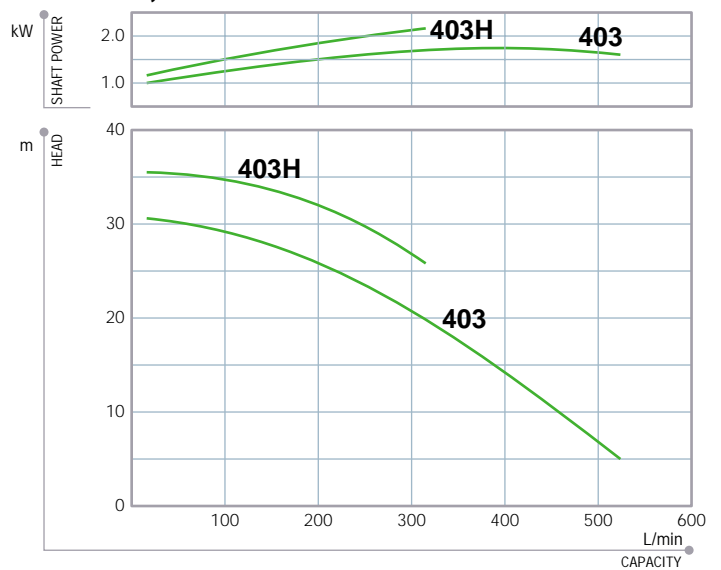

## Dimensions

### MX-70(M), 100(M)

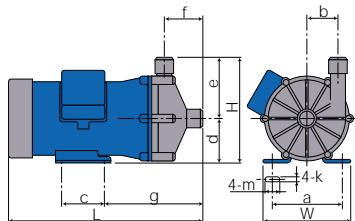

### MX-250 to 401

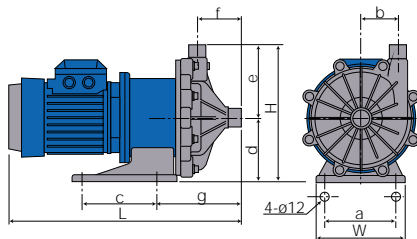

### MX-402(H), 403(H)

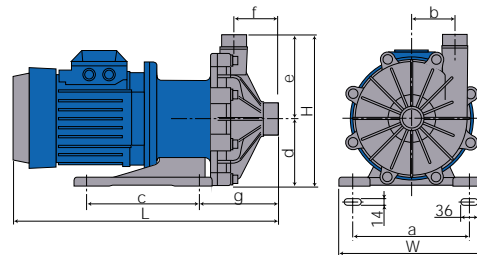

in mm

Models	W	H	L	a	b	c	d	e	f	g	k	m
<b>MX-70(M)</b>	130	155	258.5	110	48	40	65	90	53	159.5	7	11
<b>MX-100(M)</b>	150	175	319.5	110	51	70	75	100	65	162	9	27
<b>MX-250</b>	160	247.5	422	130	65	130	115	132.5	82.5	155.5	—	—
<b>MX-251</b>	160	247.5	458.5	130	65	130	115	132.5	82.5	163.5	—	—
<b>MX-400</b>	140	219	423.5	110	54	98	95	124	81	144	—	—
<b>MX-401</b>	160	249	473	130	72	130	115	134	97	178	—	—
<b>MX-402(H),403(H)</b>	260	274	478.5	208	80	200	120	154	83	151	—	—

Note : The dimensions L may differ with the type of motor installed.

## Optional accessories

### Iwaki dry running protector DR series

Model DR is electric current sensing type dry running protector. It detects the decreased load current (lower limit) to stop the pump when it runs dry or runs with air sucking in. It can detect over-load, too.

- Current figure to be set is indicated on LCD.
- Both top/bottom figures can be set.  
Top:Over-load  
Bottom:Dry running, air sucking-in operation, operation with suction side closed
- Built-in current transformer
- DIN rail mounting

#### Specification

50Hz

Model	DR-20	
Motor power	380 to 440V three phase	
Applied motor	0.75 to 15kW	
Power control	230V single phase	
Power	V	200 to 240V ±10% single phase
	Input	3.5W
Detective current	0.5 to 32.0A	
Current transformar(CT)	Built-in	
Outer dimension	D80 X W153 X H122	



DR-20

### Union joint (Option)

Special purpose union joints are available.

Material : PVC/Heat resistant PVC



## 广州晋合水处理设备有限公司



地址：广东省广州市海珠区工业大道333号华新园区7幢218  
 电话：020-88191905  
 传真：020-61139917  
 邮编：510300  
 邮箱：jinhewater@jinhewater.com  
 网址：http://www.jinhewater.com